

Single-Jet Electronic Water Meters

Digital Precision, Long-Lasting Performance, and Flexible Body Options

The Euromet AYSU SD-XX-Y series is a modern family of water meters that combines the hydraulic advantages of the single-jet measurement principle with the digital precision of an electronic calculation unit. Designed for residential and light commercial use with nominal diameters of DN15, DN20, and DN25, this series offers both brass and composite body alternatives to suit various project requirements .



Key Features:

- **Single-Jet Technology:** Operates on the principle of a single stream of water impacting the turbine, ensuring low pressure loss and high sensitivity.
- **High Measurement Range (R250):** Features a measurement ratio (Q3/Q1) of up to 250 (R250), allowing for the precise recording of even very low flow rates.
- **Long Battery Life:** Powered by a non-replaceable 3.6V lithium battery with a service life of more than 10 years .
- **Clear Digital Display:** The 10-segment LCD screen eliminates reading errors. It supports a maximum indication of 99,999.999 m³ and offers a high resolution of 0.00002 m³ for precise monitoring .
- **Body Options:** Available in durable Brass (B) or corrosion-resistant Composite (C) body options depending on the need .
- **Secure Data Storage:** Measurement data and software are stored in non-volatile memory, cannot be altered externally, and are fully secured by a sealed structure.

Security and Quality

- This product is fully compliant with the European Union 2014/32/EU (MID) Directive, OIML R 49-1:2013, and EN ISO 4064-1:2014 standards . Both mechanical and electronic sections are sealed against unauthorized access.
- For detailed technical drawings and ordering codes, please contact our sales department.





SD-xx-Y

Data Sheet

	SD-15-Y	SD-20-Y	SD-25-Y
Diameter - mm	DN15	DN20	DN25
Overload flowrate Q_4	$\leq 3,125$	$\leq 5,00$	$\leq 7,875$
Permanent flowrate Q_3	$\leq 2,50$	$\leq 4,00$	$\leq 6,30$
Transitional flowrate Q_2	$\geq 0,016$	$\geq 0,0256$	$\geq 0,0403$
Minimum flowrate Q_1	$\geq 0,010$	$\geq 0,016$	$\geq 0,0252$
Measuring range (R) Q_3/Q_1	≤ 250		
Accuracy Class	2		
Temperature class T	T 50		
Water pressure class Bar	MAP 16		
Horizontal length mm	110-190	160-190	160-260
Pressure loss class Bar	ΔP 63		
Flow profile sensivity class	U0 D0		
Orientation	H (Yatay)		



Dimensions

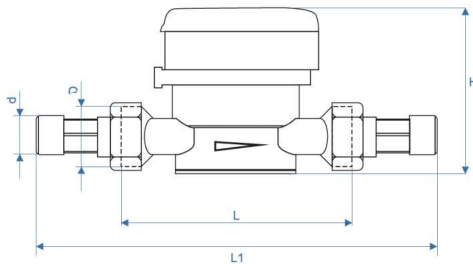

Size	DN 15	DN 20	DN 25
L	190	190	225
L1	265	265	300
D	G3/4	G1B	G1 1/4B
d	R 1/2	R 3/4	R1
H	119	119	127